

# Sky Penthouse

## Type PH1

203 sq m / 2185 sq ft

Inclusive of strata void area of  
38 sq m / 409 sq ft above Living, Dining & Dry Kitchen  
Block 6: #36-09

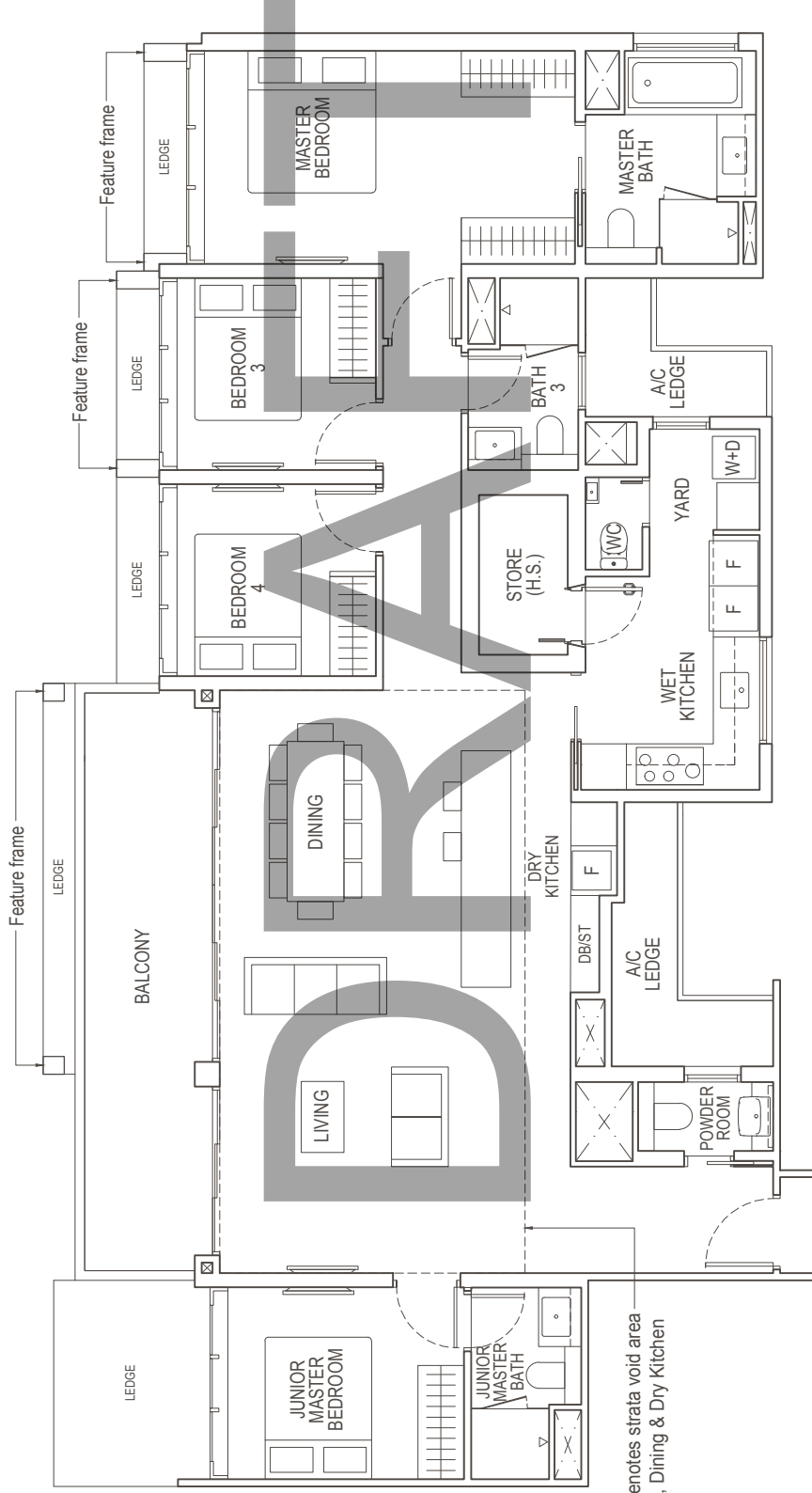

Dotted line denotes strata void area  
above Living, Dining & Dry Kitchen

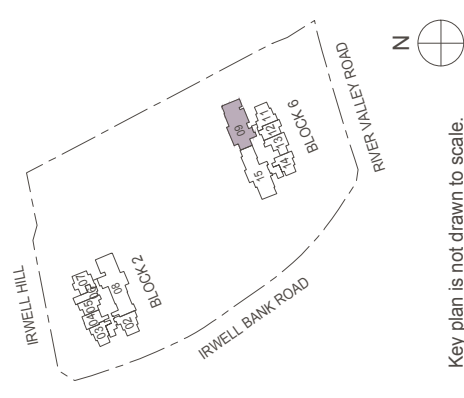

Key plan is not drawn to scale.

Area includes air-con (A/C) ledge, balcony and strata void area where applicable. The plans are subject to change as may be approved by relevant authorities. All floor plans are approximate measurements only and are subject to government re-survey. The balcony shall not be enclosed unless with the approved balcony screen. For an illustration of the approved balcony screen, please refer to the diagram annexed hereto as "Annexure 1".

# Sky Penthouse

## Type PH2

207 sq m / 2228 sq ft

Inclusive of strata void area of  
42 sq m / 452 sq ft above Living, Dining & Dry Kitchen  
Block 6: #36-15

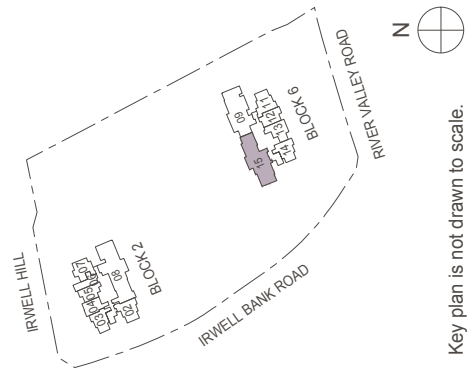
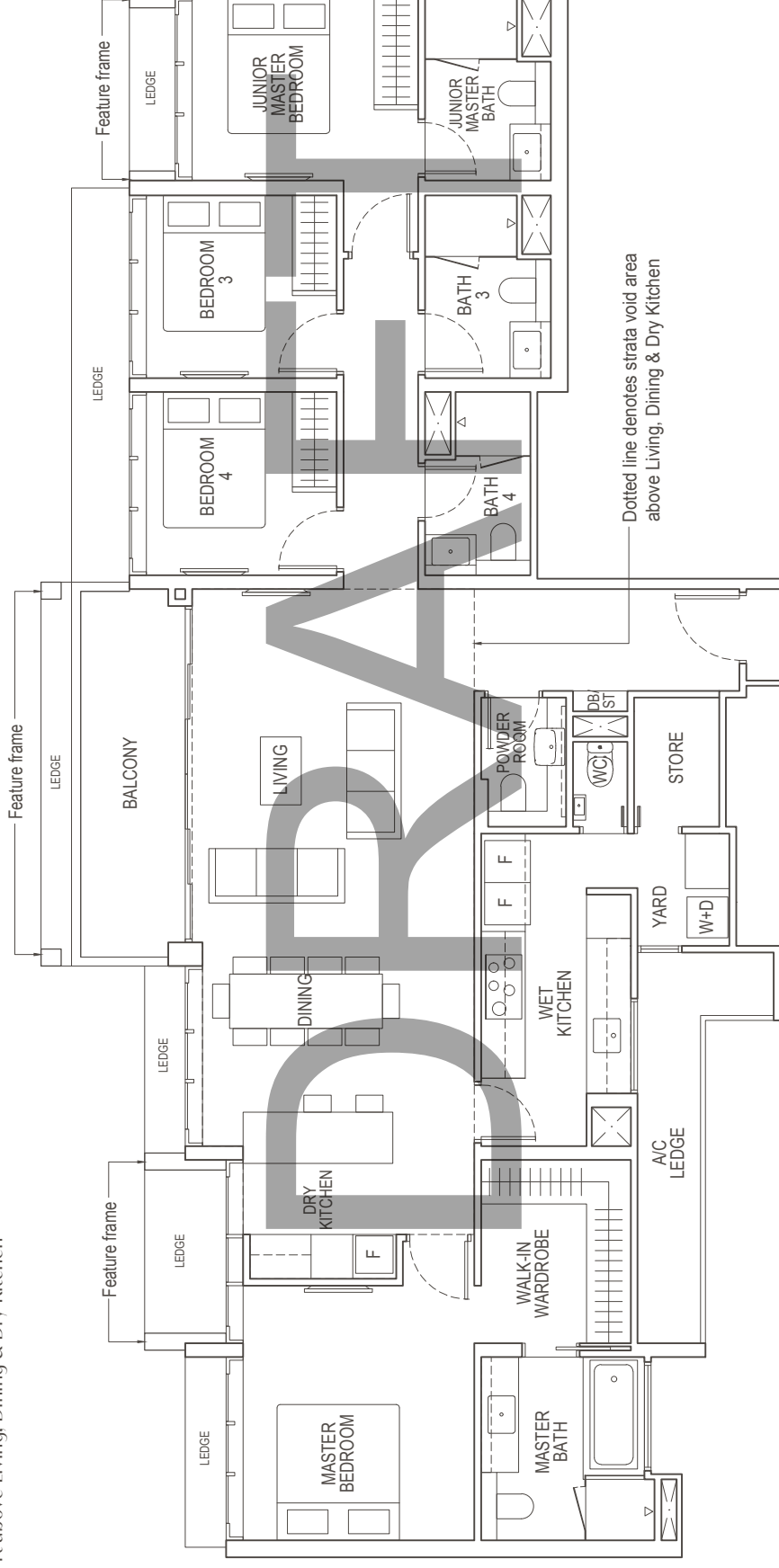

Key plan is not drawn to scale.



Area includes air-con (A/C) ledge, balcony and strata void area where applicable. The plans are subject to change as may be approved by relevant authorities. All floor plans are approximate measurements only and are subject to government re-survey. The balcony shall not be enclosed unless with the approved balcony screen. For an illustration of the approved balcony screen, please refer to the diagram annexed hereto as "Annexure 1".

# Sky Penthouse

## Type PH3

242 sq m / 2605 sq ft

Inclusive of strata void area of  
40 sq m / 431 sq ft above Living, Dining & Dry Kitchen  
Block 2: #36-08

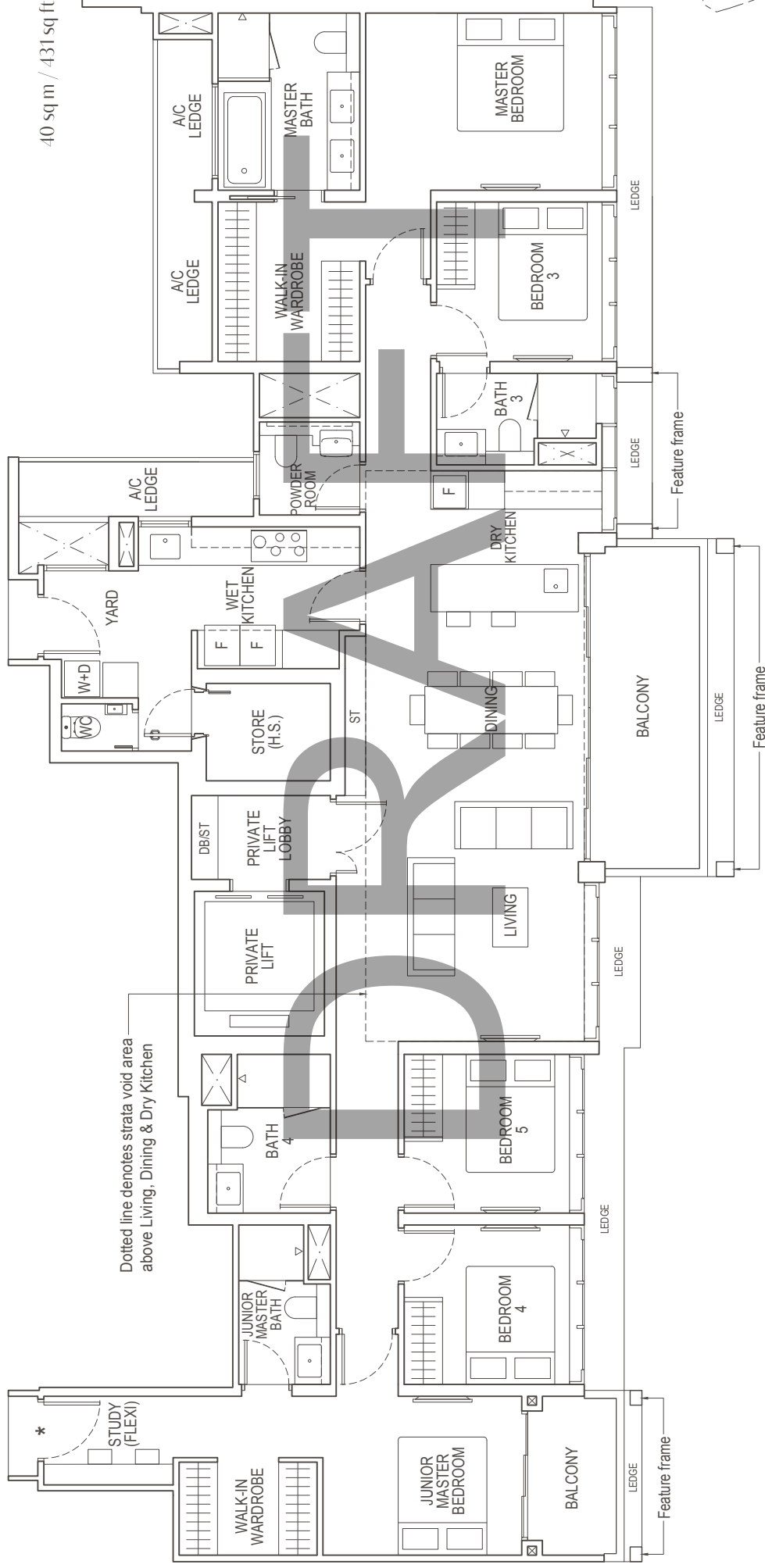

Dotted line denotes strata void area  
above Living, Dining & Dry Kitchen

\* The one-way exit door at the Junior Master Bedroom  
is for fire escape purposes only



Area includes air-con (A/C) ledge, balcony and strata void area where applicable. The plans are subject to change as may be approved by relevant authorities. All floor plans are approximate measurements only and are subject to government re-survey. The balcony shall not be enclosed unless with the approved balcony screen. For an illustration of the approved balcony screen, please refer to the diagram annexed hereto as "Annexure 1".

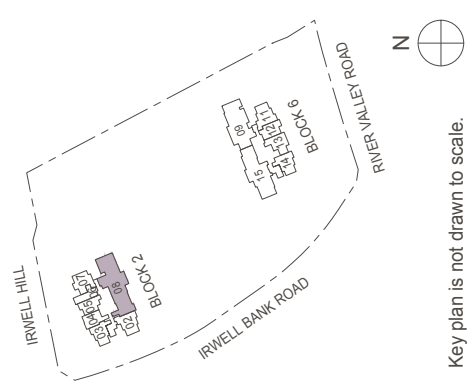

Key plan is not drawn to scale.